

面板开孔图
Panel cut out

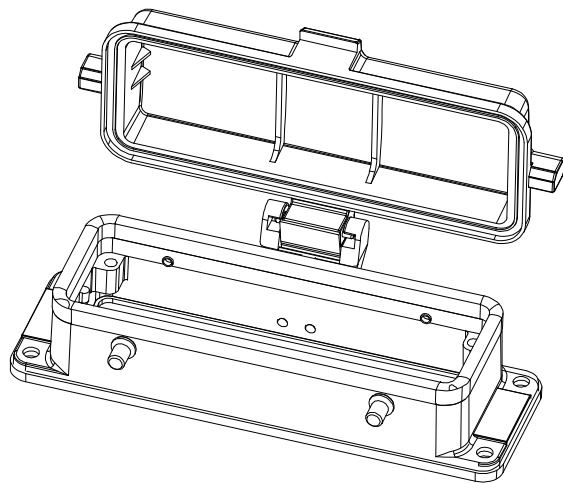

技术参数:
 - 材料: 压铸铝
 - 盖子材料: PC
 - 表面处理: 粉末喷涂
 - 颜色: Grey (灰色)
 - 温度范围: -40°C - +125°C
 - 防护等级: IP65 (联锁状态, IEC 60529)
 - 出线方向: 底部出线
 - 密封元件: NBR

Technical specification:
 - Material: Aluminium die-cast
 - Material, cover: PC
 - Surface: powder-coated
 - Colour: (grey)
 - Temperature range: -40°C - +125°C
 - Degree of Protection: IP65
 (acc.to IEC 60529 for coupled connector)
 - Cable entry: bottom entry
 - Hoods/Housings sealing: NBR

ZJKK 浙江昊科电气有限公司 ZHEJIANG HAOKE ELECTRICAL CO.,LTD		图号 Drawing No:		/			
产品代号 Part Code:		H24B-BK-4B-CV		产品料号 PART NO: 09300240302			
Date:	2018.08.23	Scale	REV	Weight	Qty	Drawn:	SHEET
	All Dimensions in mm Original Size DIN A 4	1:1.5	HK-1	/	/	Tang	1/1